

# Sistema Linear Correia Dentada

SLCD 40/ 60/ 80/ 100



SLCD 160



<b>SLCD60</b>	<b>L</b>	<b>500</b>	<b>DB</b>	<b>D01</b>	<b>GB2</b>	<b>22</b> <sup>Notes</sup>	<b>P3</b>	<b>A001</b>
Item NO.		Stroke	Auxiliary Block	Motor Mounting Position	Motor type	Hole dimension of coupling	Photoelectric Sensor	Special Order No.
SLCD40		100-4000, Gap 100	DB	D01	GB2		P1: 1 1PC	
SLCD60				D02	GB3		P2: 2 2PCS	
SLCD80				D03	GB4		P3: 3 3PCS	
SLCD100				D04			No Mark/No Sensor	
				D05				



■ Max Permissible Forces And Torques

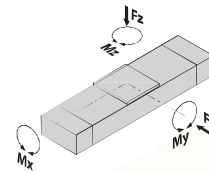

Type	40	60	60L	80	80L	100	100L
■ F(y) (N)	993	2457	5235	3131	7277	4375	11675
■ F(z) (N)	993	3375	5335	5120	7277	7860	11675
■ M(x) (N·m)	6	22	40	75	75	115	136
■ M(y) (N·m)	20	78	231	210	558	310	1322
■ M(z) (N·m)	20	78	231	210	558	310	1322

All forces and torques relate to the following:  

$$\frac{F_y}{F_y \max.} + \frac{F_z}{F_z \max.} + \frac{M_x}{M_x \max.} + \frac{M_y}{M_y \max.} + \frac{M_z}{M_z \max.} \leq 1$$

■ Motor Mounting Position Version

D01	D02	D03	D04	D05

■ Basic Specification

SLCD60		40	60	60-L	80	80-L	100	100-L	
Technical Parameters	Repetitive Accuracy (mm)	± 0.05							
	Pulley Lead (mm)	99	130		176		224		
	Belt Type	3M-10	5M-25		8M-30		8M-50		
	Maximum Speed (mm/s)	3000	5000		5000		5000		
	Maximum Payload <sup>*Note1</sup>	Horizontal (kg)	10	30	45	50	75	80	120
		Vertical (kg)	8	20	30	40	60	60	90
	Max. No-load Driving Torque (N·m)	0.1	0.35	0.35	0.5	0.5	0.9	0.9	
Max. Driving Torque (N·m)	6	13.3	13.3	49.8	49.8	105.7	105.7		
Basic Specification	Stroke (mm)	100-1500mm/100pitch		100-4000mm/100pitch					
	AC Servo Motor Output (W)	100	200/400		400/750		750/1000		
	Linear Guide	12# × 1PCS	15# × 1PCS		20# × 1PCS		25# × 1PCS		
	Max Outline of Main Engine's Cross Section (mm)	42 × 53	80 × 79		100 × 106		130 × 130		
	Home Sensor	EE-SX952-R(NPN)			EE-SX672(NPN)				

#Note 1: Date changes relevently according to different torque and accelarated speed.

#Note 2: SLCD40 without D04 and D05



## SLCD80

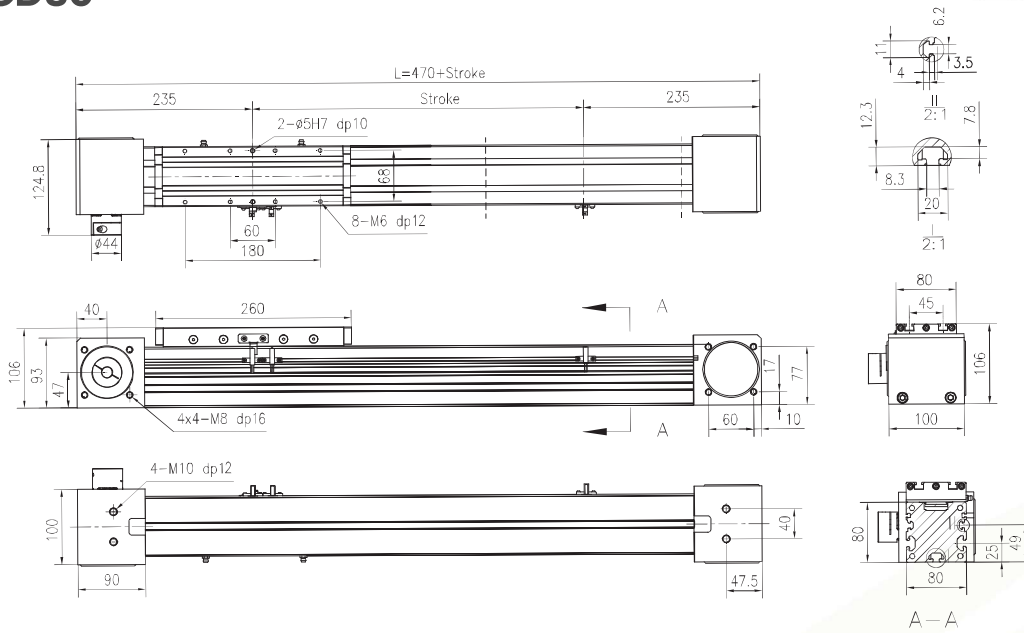

Stroke (mm)	100	200	300	400	500	600	700	800	900	1000	1100	1200	1300	1400	1500	1600	1700	1800	1900	2000
L	570	670	770	870	970	1070	1170	1270	1370	1470	1570	1670	1770	1870	1970	2070	2170	2270	2370	2470
Weight (kg)	9.1	9.9	10.8	11.6	12.5	13.4	14.2	15.1	15.9	16.8	17.7	18.5	19.4	20.2	21.1	22.0	22.8	23.7	24.5	25.4
Stroke (mm)	2100	2200	2300	2400	2500	2600	2700	2800	2900	3000	3100	3200	3300	3400	3500	3600	3700	3800	3900	4000
L	2570	2670	2770	2870	2970	3070	3170	3270	3370	3470	3570	3670	3770	3870	3970	4070	4170	4270	4370	4470
Weight (kg)	26.3	27.1	28.0	28.8	29.7	30.6	31.4	32.3	33.1	34	34.9	35.7	36.6	37.4	38.3	39.2	40.0	40.9	41.7	42.6

## SLCD100

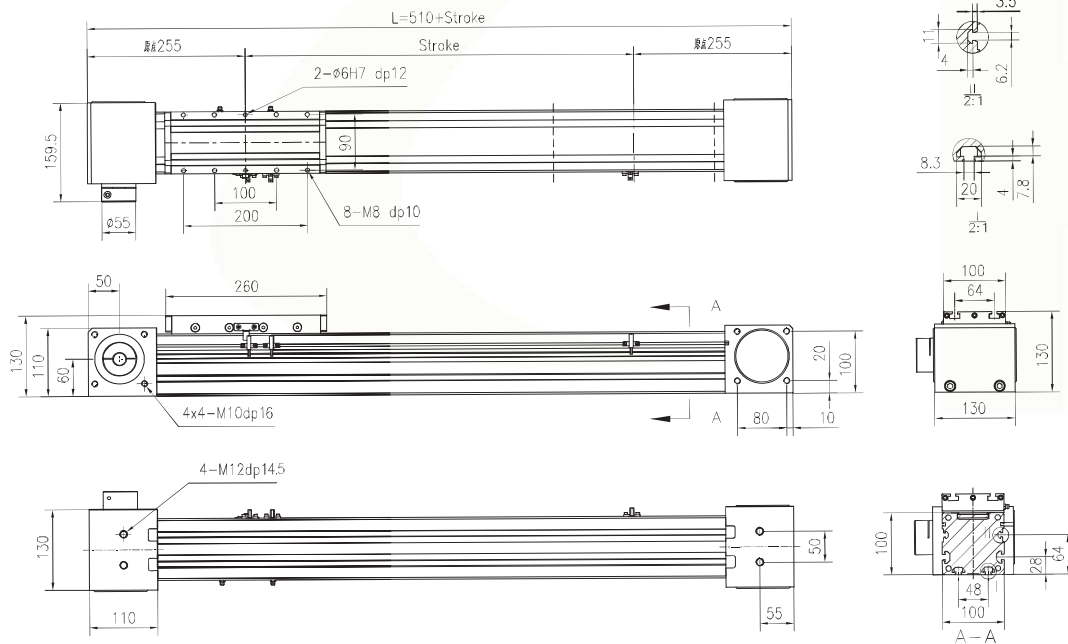

Stroke (mm)	100	200	300	400	500	600	700	800	900	1000	1100	1200	1300	1400	1500	1600	1700	1800	1900	2000
L	610	710	810	910	1010	1110	1210	1310	1410	1510	1610	1710	1810	1910	2010	2110	2210	2310	2410	2510
Weight (kg)	15.5	16.8	18.0	19.2	20.5	21.7	22.9	24.1	25.4	26.6	27.8	29.1	30.3	31.5	32.8	34.0	35.2	36.4	37.7	38.9
Stroke (mm)	2100	2200	2300	2400	2500	2600	2700	2800	2900	3000	3100	3200	3300	3400	3500	3600	3700	3800	3900	4000
L	2610	2710	2810	2910	3010	3110	3210	3310	3410	3510	3610	3710	3810	3910	4010	4110	4210	4310	4410	4510
Weight (kg)	40.1	41.4	42.6	43.8	45.1	46.3	47.5	48.7	50.0	51.2	52.4	53.7	54.9	56.1	57.4	58.6	59.8	61.0	62.3	63.5

## Code

<b>SLCD160</b>	<b>500</b>	<b>L</b>	<b>D01</b>	<b>DB</b>	<b>GB2</b>	<b>22</b> <sup>*Note3</sup>	<b>P3</b>	<b>A001</b>
Item NO.	Stroke		Motor Mounting Position	Auxiliary Block	Motor type	Hole dimension of coupling	Photoelectric Sensor	Special Order No.
ITO160	100-4000, Gap 100		D01 D02 D03 D04 D05 D06	DB	GB2 <sup>*Note3</sup> GB3 GB4		P1: 1 1PC P2: 2 2PCS P3: 3 3PCS No Mark:No Sensor	



### Max Permissible Forces And Torques

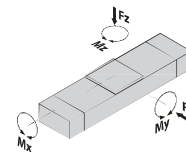

Type	160
■ F(z) (N)	9703
■ F(z) (N)	9450
■ F(y) (N)	9703
■ M(x) (N · m)	395.1
■ M(y) (N · m)	356.2
■ M(z) (N · m)	348.8

All forces and torques relate to the following:

$$\frac{F_y}{F_y \max.} + \frac{F_z}{F_z \max.} + \frac{M_x}{M_x \max.} + \frac{M_y}{M_y \max.} + \frac{M_z}{M_z \max.} \leq 1$$

### Motor Mounting Position Version

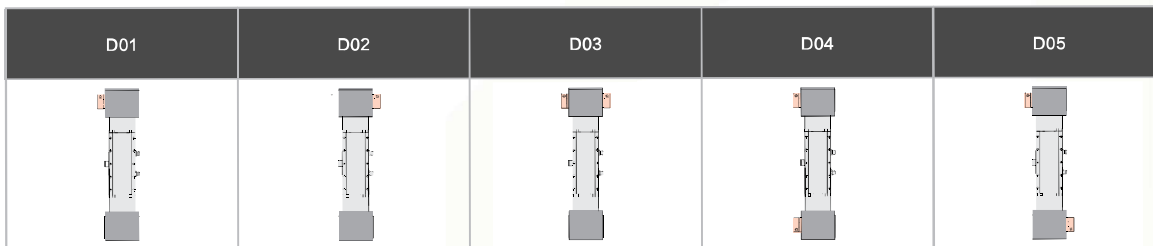

### Basic Specification

SLCD		160	
Technical Parameters	Repetitive Accuracy (mm)	±0.05	
	Pulley Lead (mm)	176	
	Belt Type	8M-70	
	Maximum Speed (mm/s)	5000	
	Maximum Payload <sup>*Note1</sup>	Horizontal (kg)	160
		Vertical (kg)	120
	Max. No-load Driving Torque (N · m)	1.2	
	Max. Driving Torque (N · m)	112.7	
Basic Specification	Stroke (mm)	100-4000mm / 100 Pitch	
	AC Servo Motor Output (W)	750W-1000W	
	Linear Guide	20# × 2pcs	
	Max Outline of Main Engine's Cross Section (mm)	166 × 106	
	Home Sensor	EE-SX672(NPN)	

#Note 1: Date changes relevently according to different torque and accelarated speed.

## SLCD160

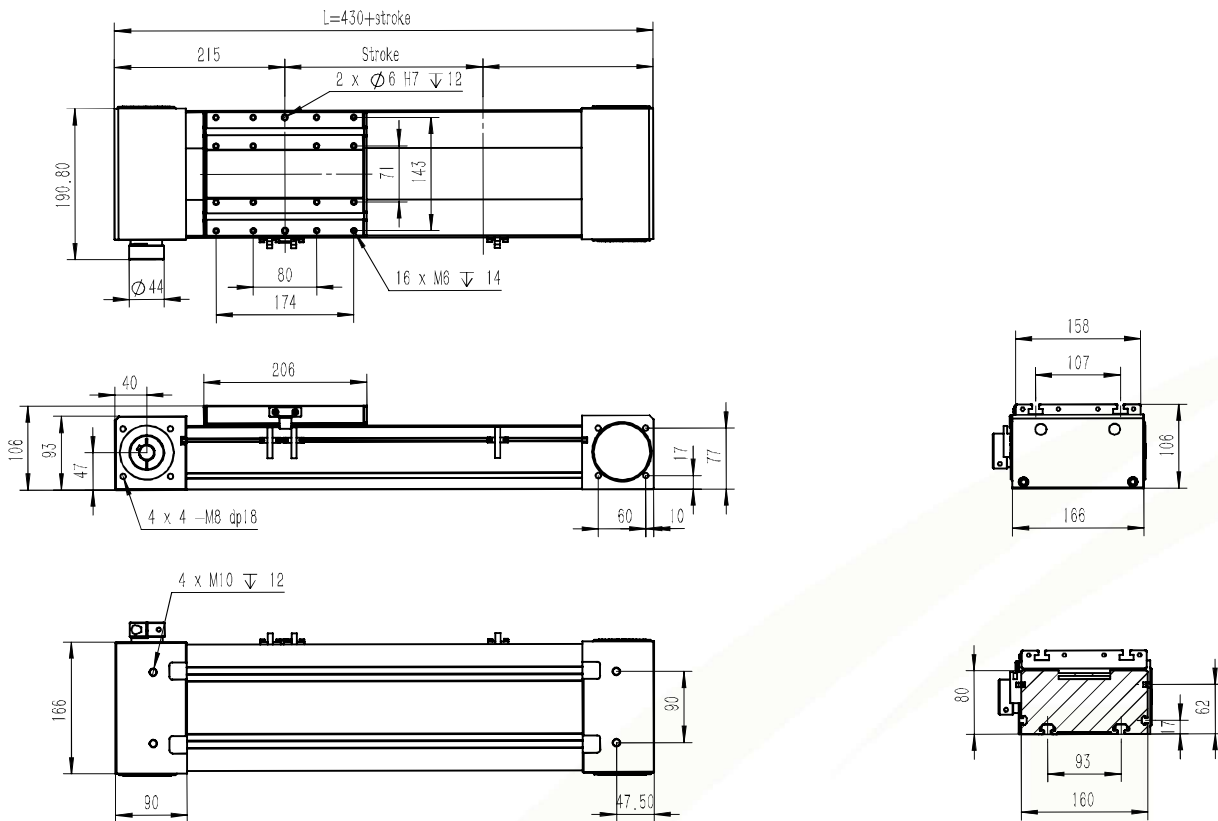

Stroke (mm)	100	200	300	400	500	600	700	800	900	1000	1100	1200	1300	1400	1500	1600	1700	1800	1900	2000
L	530	630	730	830	930	1030	1130	1230	1330	1430	1530	1630	1730	1830	1930	2030	2130	2230	2330	2430
Weight (kg)	17.4	18.9	20.4	21.9	23.4	24.9	26.4	27.9	29.4	30.9	32.4	33.9	35.4	36.9	38.4	39.9	41.4	42.9	44.4	45.9
Stroke (mm)	2100	2200	2300	2400	2500	2600	2700	2800	2900	3000	3100	3200	3300	3400	3500	3600	3700	3800	3900	4000
L	2530	2630	2730	2830	2930	3030	3130	3230	3330	3430	3530	3630	3730	3830	3930	4030	4130	4230	4330	4430
Weight (kg)	47.7	48.9	50.4	51.9	53.4	54.9	56.4	57.9	59.4	60.9	62.4	63.9	65.4	66.9	68.4	69.9	71.4	72.9	74.4	75.9